

For Lease

Office Space Available

2818 N. Sullivan Spokane Valley, Washington

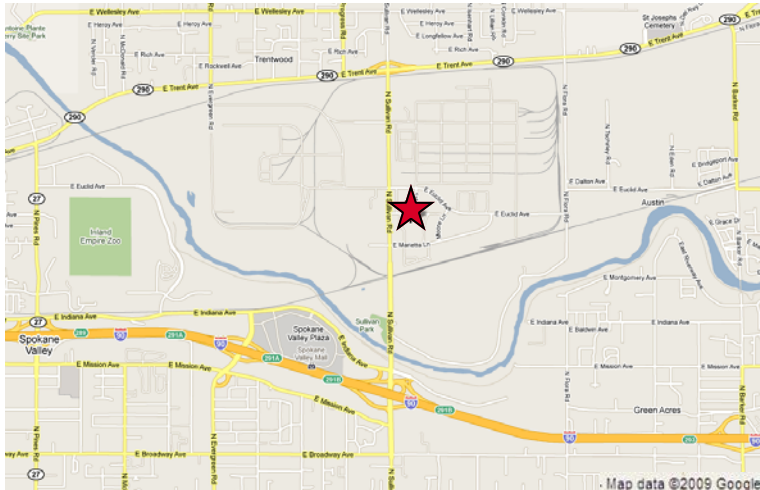

- Lease Rate:
\$6.00/SF NNN
- Building Size:
29,960 SF
- Open Floor Plan with
125 8'3" x 8' 3"
existing work stations
- Numerous Offices and
Conference Rooms
- 5.5/1000 Car Parks—
Can expand to
9.5/1,000 Car Parks
- Just North of I-90,
located in Spokane
Valley with close
proximity to Northern
Idaho
- Ideal for a call center
- Facility has back-up
generator
- Site and Floor Plan on
Reverse

Contact information

Jeff A. McGougan

509 622 3576

jmcgougan@naiblack.com

Jim Orcutt

509 622 3558

jorcutt@naiblack.com

Black Commercial, Inc.
107 S. Howard, Suite 500

Spokane, WA 99201

direct 509 623 1000

fax 509 622 3500

www.naiblack.com



Commercial Real Estate Services, Worldwide.

The information contained herein has been given to us by the owner of the property or other sources we deem reliable, we have no reason to doubt its accuracy, but we do not guarantee it. All information should be verified prior to purchase or lease.

For Lease

Office Space Available

2818 N. Sullivan Spokane Valley, Washington

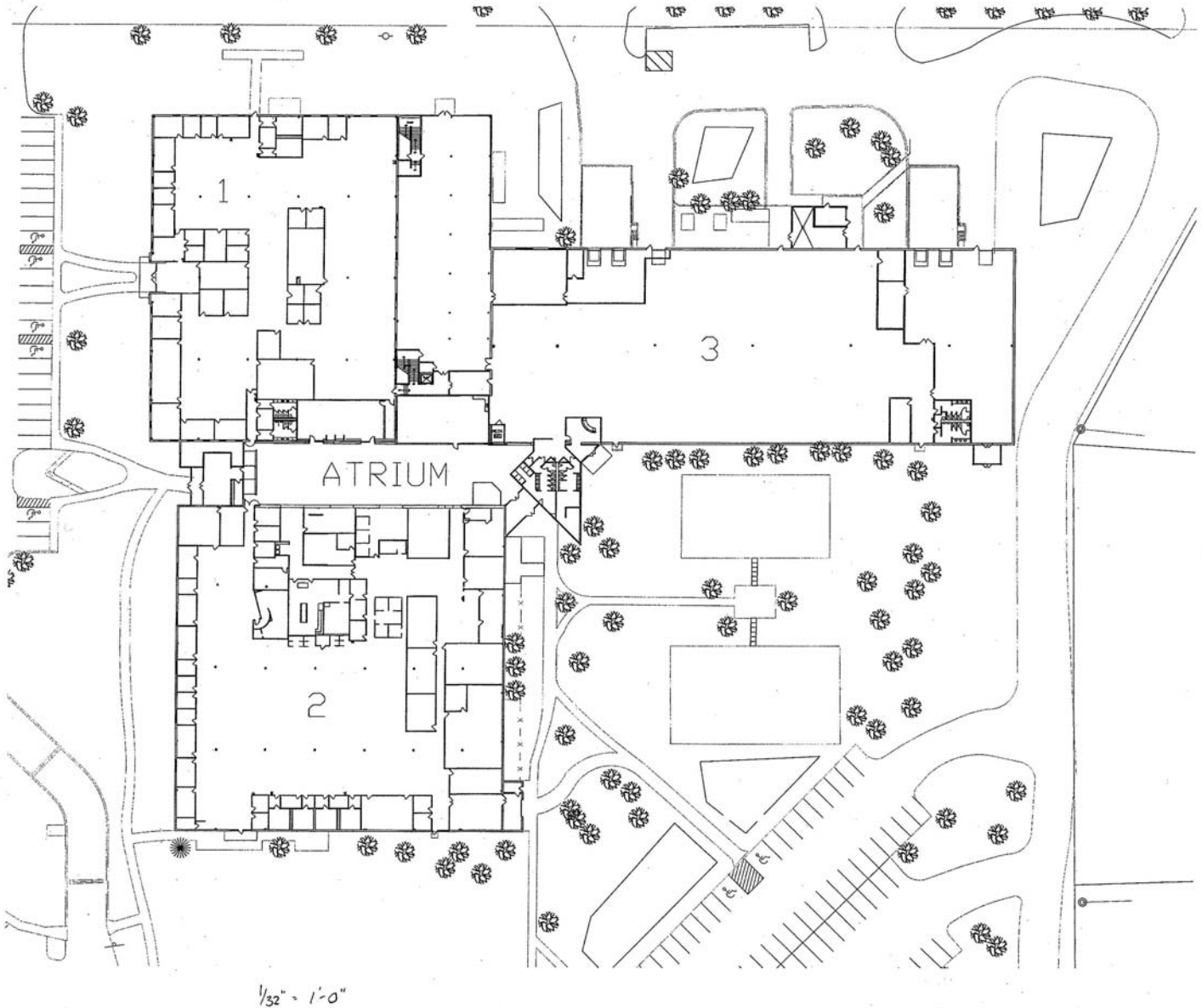

Floor Plan

Contact information

Jeff A. McGougan

509 622 3576

jmcgougan@naiblack.com

Jim Orcutt

509 622 3558

jorcutt@naiblack.com

Black Commercial, Inc.
107 S. Howard, Suite 500

Spokane, WA 99201

direct 509 623 1000

fax 509 622 3500

www.naiblack.com

NAI Black

Commercial Real Estate Services, Worldwide.

The information contained herein has been given to us by the owner of the property or other sources we deem reliable, we have no reason to doubt its accuracy, but we do not guarantee it. All information should be verified prior to purchase or lease.