

The Cannery

1200 HARBOUR WAY SOUTH, RICHMOND, CA 94801



The Cannery Building

The Cannery is a historic multi-tenant industrial building. Each unit has concrete flooring, exposed wood truss ceilings, skylights, utility sinks, fluorescent lighting, and three-phase power.

On-site AC Transit Line 74 Bus Stop and the Red & White Ferry is within walking distance.

Suite 101 Available

- +/- 3,284 Rentable SF
- \$1.60 PSF Industrial Gross
- 1 Grade Door
- Available Nov. 1, 2021 (confirm w/ broker)



Dante Guazzo
NAINORCAL.COM

Dante Guazzo
Vice President
dguazzo@nainorcal.com
510.336.4714
CalDRE #01301236

South Wing Floorplan

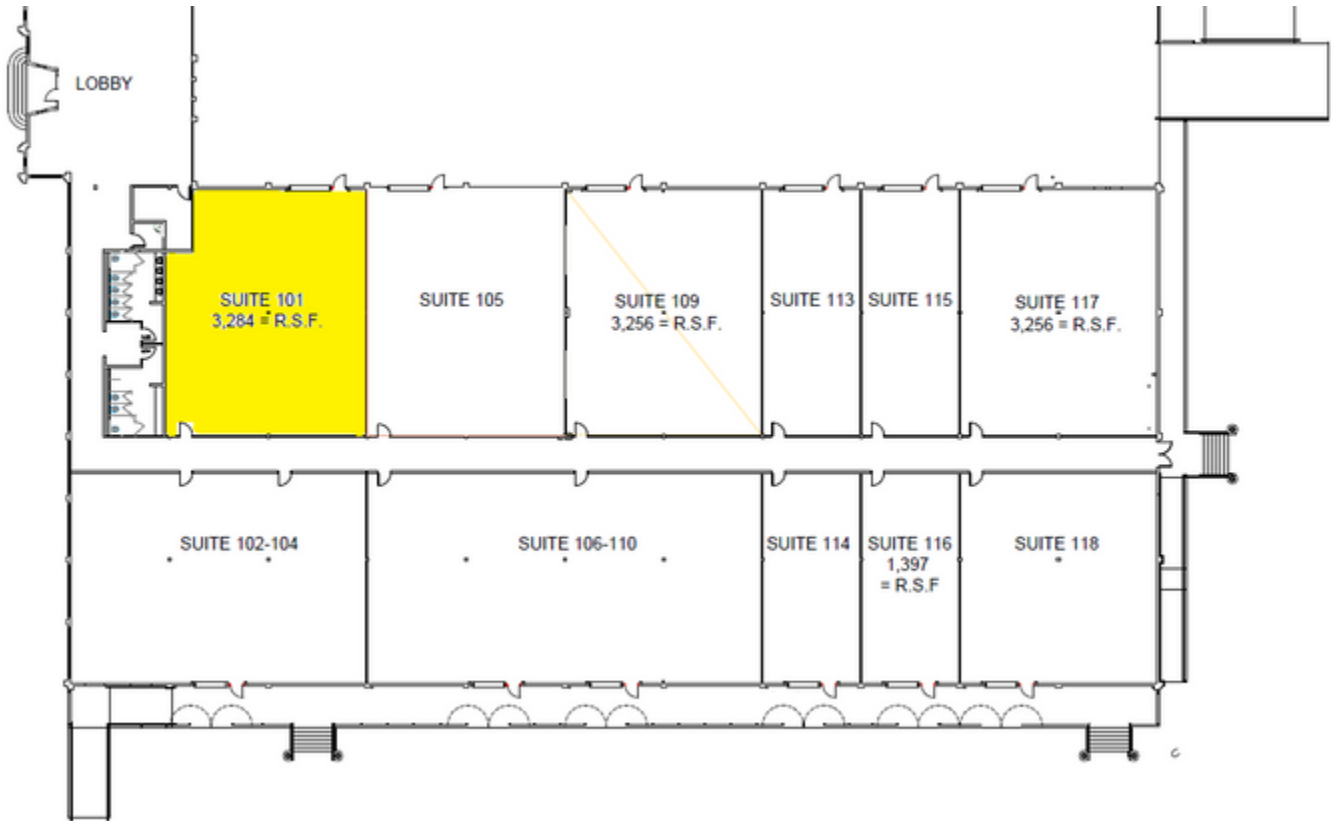

Location Information



For More Information

Dante Guazzo
Vice President
dguazzo@nainorcal.com
510.336.4714
CalDRE #01301236