

INDUSTRIAL/FLEX SPACE FOR LEASE



+/- 10,000 – 15,300 RSF INDUSTRIAL / FLEX SPACE

PINER BUSINESS CENTER: 917 & 921 PINER ROAD, SANTA ROSA, CA



ALASKA, NORTHERN CALIFORNIA,
CENTRAL CALIFORNIA, SOUTHERN
CALIFORNIA, OREGON AND
WASHINGTON

WWW.STGGROUP.COM

**NEGOTIABLE RATE
MODIFIED GROSS**

(PG&E, Janitorial & IT not included)

CONTACT

Jim Ballard | Director of Leasing
JBallard@stgroup.com

Kassandra Delgado | Leasing Associate
kdelgado@stgroup.com

THE STG GROUP
1304 Southpoint Blvd., Suite 280
Petaluma, CA 94954
707.569.9000



OVERVIEW

- LOCATED W. OF HWY 101, E. OF AIRWAY DR.
- EAST ACCESS TO HWY 101, CLEVELAND AVE, RANGE AVE, HOPPER AVE, INDUSTRIAL AVE, MARLOW RD
- CLOSE PROXIMITY TO RESTAURANTS, AUTO SERVICES, GROCERY STORES, CODDINGTOWN MALL
- PARKING 2.5:1000
- POWER 120-208 V, 3 PHASE
- ZONING IL, LIGHT INDUSTRIAL (Allowable Uses: Light manufacturing, R&D, indoor commercial recreation facility, building/landscape/farm material sales, accessory office)



SPACE AVAILABLE:

Suite 917-A & 917-B

+/- 15,300 rsf

Large open space with 1-2 offices, kitchen, 6 roll-up doors, 2 restrooms (men & women)



+/-10,000 -15,300 RSF INDUSTRIAL/FLEX SPACE

PINER BUSINESS CENTER: 917-A-B & 921-B PINER ROAD, SANTA ROSA, CA

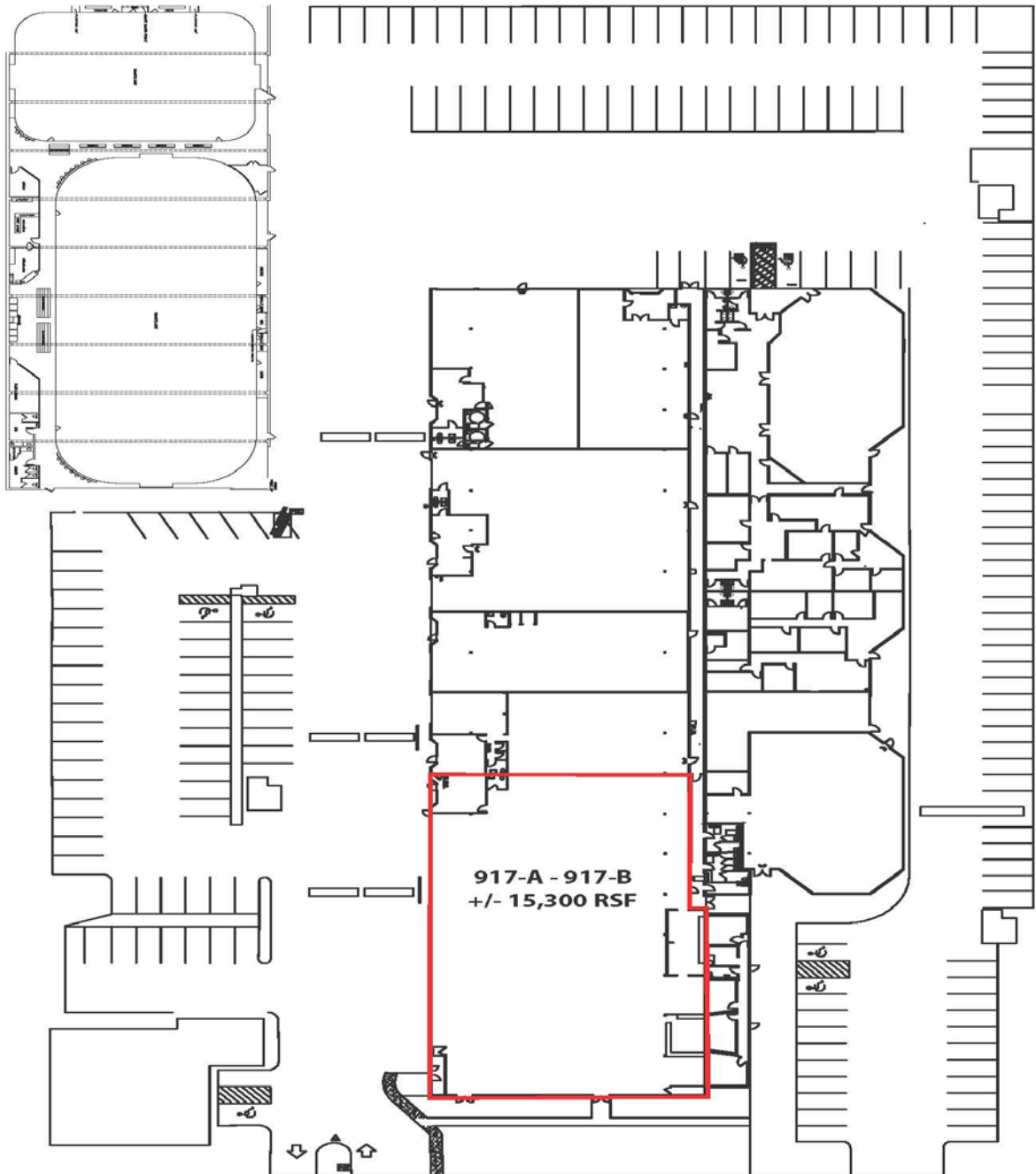

PINER ROAD



Jim Ballard, President Ballard@stgroup.com | Kassandra Delgado, Leasing Associate kdelgado@stgroup.com
1304 Southpoint Blvd., Suite 280, Petaluma, CA 94954 | 707.569.9000 Office | 707.569.8582 Fax | www.stgroup.com
Alaska, Northern California, Central California, Southern California, Illinois, Oregon, and Washington

The above information, while not guaranteed, has been secured from sources we believe to be reliable. Subject to error, change or withdrawal. An interested party should verify the status of the property and the information herein.